

SEWERAGE LEGEND

WASTE WATER/ SEWER LINE (UPVC PIPE)

TOILET WASTE/ SEWER LINE (UPVC PIPE)



ENGINEER'S TEAM

430 E 8TH ST STE 8017  
HOLLAND MI 49423

ENGRTTEAM.COM

SUPPORT@ENGRTTEAM.COM

OWNER:

GENERAL ARRANGEMENT PLAN

ROCK LEOPARD BREWERY  
13 WAGTAIL WALK, LONDON, SE2 9FE

SEAL:

Release for construction

PLUMBING  
SEWERAGE PLAN

Drawn by: Engr. Al Amin

Checked:

Date: NOV, 24.

P. 1

Scale: 1:100

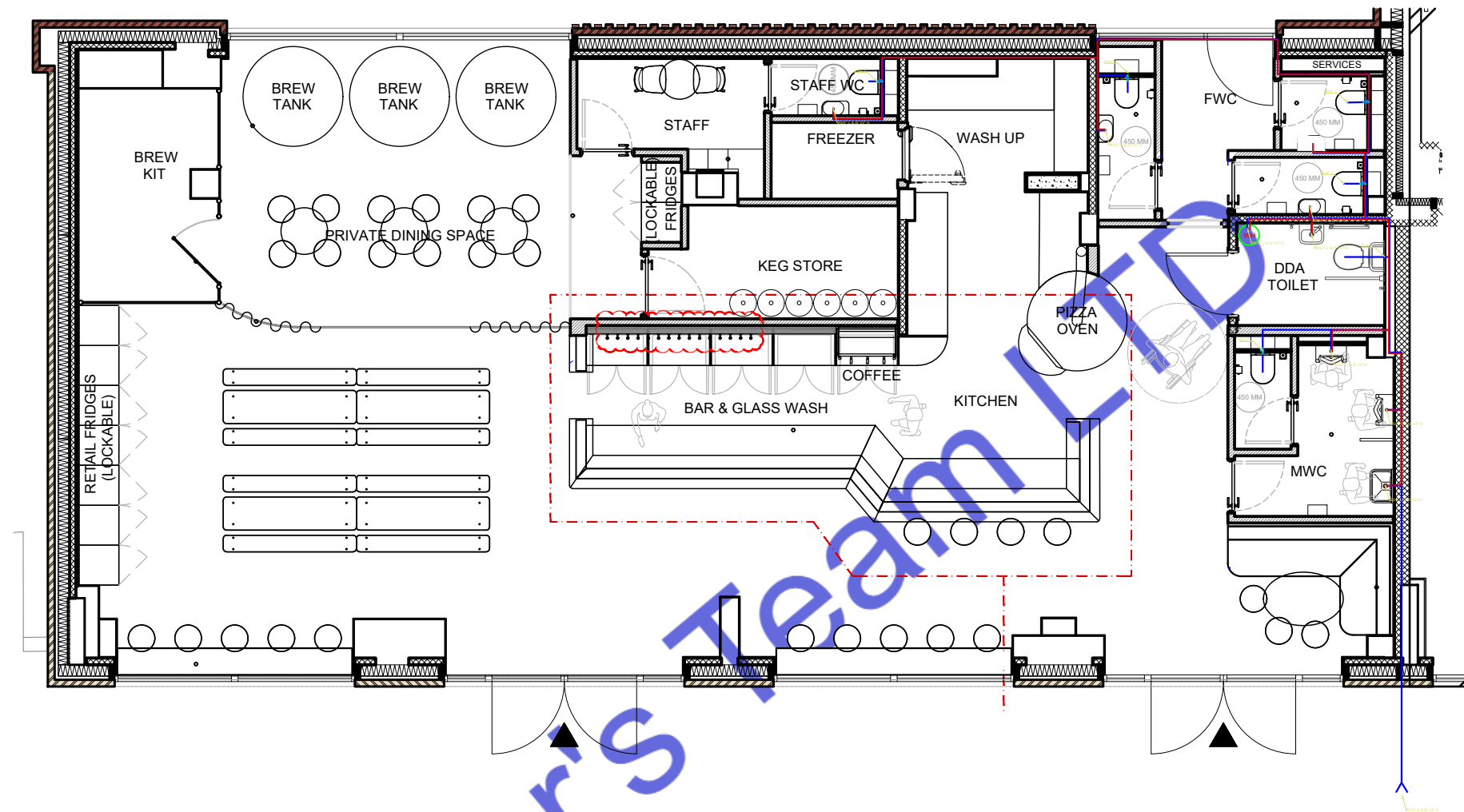

PLUMBING LEGEND	
	BALL VALVE (BV)
	GATE VALVE (GV)
	MIXING VALVE (MV)
	FLOOR CLEAN OUT (FCO)
	FLOOR DRAIN (FD)
	HUB DRAIN (HD)
	FLOOR SINK (FS)
	PIPE TURNING UP
	PIPE TURNING DOWN
	EXISTING PIPE
	NEW PIPE
LINES TYPE LEGEND	
	COLD WATER LINE (CW)
	HOT WATER LINE (HW)
	SEWER LINE (S)
	GAS LINE (G)



## ENGINEER'S TEAM

430 E 8TH ST STE 8017  
HOLLAND MI 49423

ENGRTEAM.COM

SUPPORT@ENGRTEAM.COM

### OWNER:

#### GENERAL ARRANGEMENT PLAN

ROCK LEOPARD BREWERY  
13 WAGTAIL WALK, LONDON, SE2 9FE

### SEAL:

Release for construction

### PLUMBING WATER SUPPLY PLAN

Drawn by: Engr. Al Amin

Checked:

Date: NOV, 24.

P. 2

Scale: 1:100

#### Note:

This Plumbing Layout Plan for "Rock Leopard Brewery, 13 Wagtail Walk, London, SE2 9FE" has been prepared in full compliance with current UK plumbing regulations and best practices. Key codes and standards applied include:

- Building Regulations Part H: Outlining drainage and waste disposal standards, ensuring effective wastewater management and system reliability. This includes specific sizing and material requirements to minimize risk and ensure health and safety compliance.
- Water Supply (Water Fittings) Regulations 1999: Governing all aspects of water supply systems, this regulation prevents contamination and promotes efficient water usage, particularly relevant for brewery operations.
- BS EN 806 & BS 8558: Establishing guidelines for the design, installation, and maintenance of potable water systems to meet safety standards and avoid contamination in commercial settings.
- Updated Part L (2023): Implementing energy efficiency requirements for heating and hot water systems. Compliance here aligns with the industry's push towards sustainability and efficiency, particularly in reducing carbon impact for high-use water facilities like breweries.
- Future Homes Standard (FHS): Although fully effective in 2025, aspects of this evolving standard have been proactively incorporated, focusing on minimizing carbon emissions and preparing for future regulatory requirements in commercial plumbing setups.

This comprehensive adherence to standards ensures that the plumbing systems at Rock Leopard Brewery not only meet current safety and efficiency criteria but also anticipate future regulatory expectations, supporting both operational and environmental sustainability.

